



**DEPARTMENT OF NATURAL RESOURCES  
STATE OF MICHIGAN  
TIMBER SALE PROSPECTUS #7424**

**SCHEDULED SALE DATE AND TIME: 9:00 a.m. (local time) on May 13, 2024.**

**LOCATION: GRAYLING MGMT UNIT, 1955 HARTWICK PINES ROAD, GRAYLING, MI 49738.**

**CONTACT NAME: Thomas Barnes**

**PHONE NUMBER: (989) 348-6371**

**PROSPECTUS NOTE:** The bidder is advised to inspect the sale area and review the location, estimated volumes, operating costs and contract terms of proposed sales. Please be aware that some landowners may request 60 days or more notice for access across their land.

Notice is hereby given that bids will be received by the Unit Manager, GRAYLING MANAGEMENT UNIT, for certain timber on the following described lands:

Fast Map Pine (72-011-23) / T27N, R03W, SEC. 21, W1/2SW,NWSE.

Crawford County, Advertised Price \$15,425.25, 28.3 Acres, Jack Pine, Red Pine.

SALE NOTE: Timber is located on military controlled lands and therefore is non-certified. National guard notification required prior to opening sale. Sale is accessed off Lewiston Grade Road (seasonal county road and snowmobile trail). Cruise error is high due to small treatment sizes. Payment Unit 3 has been cut tree marked with blue paint and has old orange paint that needs to be ignored.

A recreation site such as a trail, pathway, or campground is within the sale area or the vicinity. Certain restrictions/specifications may be applicable including time restrictions.

## TIMBER SALE INFORMATION

Fast Map Pine (72-011-23)

T27N, R03W, SEC. 21.

Crawford County (Advertised Price \$15,425.25)

**SALE NOTE:** Timber is located on military controlled lands and therefore is non-certified. National guard notification required prior to opening sale. Sale is accessed off Lewiston Grade Road (seasonal county road and snowmobile trail). Cruise error is high due to small treatment sizes. Payment Unit 3 has been cut tree marked with blue paint and has old orange paint that needs to be ignored.

A recreation site such as a trail, pathway, or campground is within the sale area or the vicinity. Certain restrictions/specifications may be applicable including time restrictions.

A timber sale contract for this lump sum, sealed bid timber sale will be awarded to the responsible bidder offering the highest sealed bid price. All units of volume listed below were estimated using the Inventory Manager computer program and the new Michigan taper model. Bids must be at or above the following advertised price for each product and species:

<u>PRODUCTS &amp; SPECIES</u>	<u>ESTIMATED UNITS*</u>		<u>ADVERTISED PRICE</u>
Sawtimber			
Red Pine	25.5	MBF	\$ 134.00 / MBF
Pulpwood			
Balsam Fir	14	Cords	\$ 38.90 / Cord
Jack Pine	58	Cords	\$ 23.10 / Cord
Mixed Hardwood	3	Cords	\$ 31.75 / Cord
Northern Pin Oak	2	Cords	\$ 26.55 / Cord
Quaking Aspen	19	Cords	\$ 30.65 / Cord
Red Pine	155	Cords	\$ 56.25 / Cord
Scotch Pine	23	Cords	\$ 9.00 / Cord
White Pine	19	Cords	\$ 24.60 / Cord

\* The total volume is statistically estimated within plus (+) or minus (-) 25.73 percent. There are an estimated 358 cords on this timber sale, plus or minus 92 cords at the 95% confidence level. The estimated units are final and not subject to adjustment. Prospective bidders are urged to examine this timber and to make their own estimates of quantity and quality.

### **BOND AND PAYMENT SCHEDULE:**

1. A bond in the amount of \$1,000.00 to insure faithful performance of the conditions of the contract will be deposited by the successful bidder within 21 days of the sale award.
2. Cutting in any sale or unit without the required advance payment would be considered a trespass.
3. Total payment must be paid in advance or according to the following schedule:
  - (a) Ten percent (10%) of the sale value must be paid within 21 days of the sale award.
  - (b) The 10% down payment will be credited towards the first unit cut.
  - (c) Payment for each of the following units must be made before cutting begins in that unit:

PAYMENT UNIT NUMBER	PERCENT OF TOTAL SALE VALUE
01	13.2%
02	29.7%
03	57.1%
4. If no cutting takes place, the 10% down payment will not be refunded.
5. Operations on the contract issued will terminate on 06/30/2026.

### **SALE STATISTICS**

Volumes were calculated in cubic feet using the Michigan taper model. Cubic foot volume includes all wood inside bark for the product indicated. For display purposes, cubic feet were converted to cords and MBF using a simple conversion factor, e.g. 79 cubic feet per cord and 185 cubic feet per MBF. The cubic foot volumes are precise; the cords and MBF volumes are not. Cubic foot volume cannot be directly converted to cords or boards with precision.

### **SALE VOLUMES**

The total estimated sale volume may not equal the sum of the species/products due to the nature of statistical calculations associated with double sampling methodology.

VOLUME			STATISTICAL RANGE IN CORDS	
TOTAL CUBIC FEET	TOTAL CORDS	PERCENT ERROR	MINIMUM	MAXIMUM
28,258	358	25.73%	266	450

## VDU VOLUMES

A VDU is a Volume Determination Unit. Volumes and their associated statistics are calculated at the VDU level and summarized to the sale level. There is often a one to one relationship between a VDU and a Payment Unit, but not always, depending on the cruise design. Refer to the VDU TO PAYMENT UNIT table.

VDU	VOLUME		PERCENT ERROR	RANGE IN CORDS	
	TOTAL CUBIC FEET	TOTAL CORDS		MINIMUM	MAXIMUM
46	5,008	63	23.60%	48	78
47	5,002	63	79.08%	13	113
48	2,812	36	57.48%	15	56
49	2,991	38	96.55%	1	74
56	12,445	158	48.27%	81	234
<b>TOTAL:</b>	<b>28,258</b>	<b>358</b>		<b>160</b>	<b>556</b>

## VDU TO PAYMENT UNIT

When a VDU is associated with more than one Payment Unit (PU), the VDU volumes are assigned to the PU based on acres of the VDU within the PU.

VDU	VDU ACRES	PU	PU ACRES
46	5.4	2	5.4
47	6.6	2	6.6
48	5.5	2	5.5
49	3.5	1	3.5
56	7.3	3	7.3
<b>TOTAL:</b>	<b>28.3</b>		<b>28.3</b>

## DESCRIPTION OF TIMBER BY PU (PU)

PU	MARKET GROUP	PRODUCT	QUANTITY	UNIT	ACRES	ADVERTISE PRICE
1	Red Pine	Sawtimber	2.1	MBF	3.5	\$2,032.40
	Mixed Hardwood	Pulpwood	2	Cords		
	<i>Red Maple</i>		2	<i>Cords</i>		
	Red Pine		30	Cords		
2	Balsam Fir	Pulpwood	14	Cords	17.5	\$4,576.00
	Jack Pine		58	Cords		
	Mixed Hardwood		1	Cords		
	<i>Black Cherry</i>		1	<i>Cords</i>		
	Northern Pin Oak		2	Cords		
	Quaking Aspen		19	Cords		
	<i>B. T. Aspen</i>		2	<i>Cords</i>		
	<i>Quaking Aspen</i>		17	<i>Cords</i>		
	Red Pine		24	Cords		
	Scotch Pine		23	Cords		
	White Pine		19	Cords		
3	Red Pine	Sawtimber	23.4	MBF	7.3	\$8,816.85
	Red Pine	Pulpwood	101	Cords		
TOTAL:			25.5	MBF		
TOTAL:			293	Cords		

## **Sale Specific Conditions & Requirements**

**Sale Name: Fast Map Pine**

**Sale Number: 72-011-23 Seq#: 2**

### **1 - Sale Area**

#### **1.2 - Boundaries**

##### **1.2.1 - Painted boundaries (9/19)**

The sale boundary and Payment Unit boundaries are marked and identified by blue and red paint, or are unpainted and identified by a recreational trail and a clearcut. Exterior sale boundary lines against private property are marked with blue paint. Exterior sale boundary lines against state are marked with red paint, with the exception of the entirety of Payment Unit 1, which is unpainted and identified by the surrounding clearcut & Lewiston Grade, and the southern boundary of Payment Unit 2, which is unpainted and identified by Lewiston Grade. The painted boundary line trees are not Included Timber and are to be protected.

### **2 - Timber Specifications**

#### **2.1 - Included Timber**

##### **2.1.1 - Clearcut unit(s) with unmerchantable trees (6/14)**

Within Payment Unit(s) 2, cut all trees that are two (2) inches or more at DBH.

##### **2.1.3 - Cut tree marked unit(s) (12/08)**

Within Payment Unit(s) 1, all trees are designated for cutting when marked with orange paint above and below stump height, regardless of merchantability.

Within Payment Unit 3, all trees are designated for cutting when marked with blue paint above and below stump height, regardless of merchantability.

### **3 - Payments**

#### **3.4 - Damaged Timber**

##### **3.4.1 - Damaged timber (7/16)**

General Condition and Requirement 3.4 Damaged Timber, defines liquidated damages for undesignated live merchantable trees which are cut or injured. Within the Sale Area, if more than 10% of trees (> 4.5" DBH) within a specified area of the sale are damaged, liquidated damages will be assessed for all trees damaged. Rates will be in accordance with General Condition and Requirement 3.4 Damaged Timber.

### **4 - Transportation**

#### **4.1 - Construction**

##### **4.1.6 - Road construction (1/09)**

Construction of new roads or improvements of existing roads shall be done in such a way as to minimize the environmental and visual impacts. Merchantable trees shall be cut and utilized unless otherwise directed. Non-merchantable trees shall be severed and laid flat on the ground. Slash shall be scattered, and not left in windrows and kept a minimum of 10 feet back from the road edge. Stumps shall be set upright, not left on edge, and be moved at least 10 feet away from the road edge. Disturbed soil shall be feathered into the woods and not left in berms or windrows.

##### **4.1.7 - Road closure (10/11)**

All new roads built into the sale must be blocked to vehicle traffic upon completion of the sale. Overgrown roads that are reopened shall be considered new roads. In general, this will require constructing a four (4') foot high berm of stumps and logs covered with earth. Stumps and brush must be placed along the remainder of the trail. These roads must be rendered impassable to cars and trucks. All stumps from road building and landing construction must be reserved to block any newly constructed roads upon completion of the sale. These stumps must be scattered along the road system to prohibit vehicular movement. Contact the Sale Administrator for specific details of design and placement.

#### 4.1.11 - Permits (2/12)

The will secure any necessary permits that may be required.

## 5 - Operations

### 5.1 - Notification

#### 5.1.5 - National Guard notification (2/15)

This sale is upon lands utilized for training by the Michigan National Guard - Camp Grayling. A minimum of five (5) business days prior to opening this sale, the producer must request that the sale administrator contact the military for information regarding training plans that may impact sale operations.

### 5.2 - Conduct of Operations

#### 5.2.2 - Hazard Trees/Snags

##### 5.2.2.1 - Den trees (10/16)

Obvious hollow and/or den trees shall be protected and left standing unless they are a safety hazard.

#### 5.2.3 - Operating Restrictions

##### 5.2.3.3 - Bark slippage restriction (3/09)

Within Payment Unit(s) 1 & 3, unless changed by written agreement, cutting and skidding are not permitted during the period of April 15 to July 15. This restriction is because of bark slippage.

##### 5.2.3.6 - Bark beetle restriction (12/08)

In the event drought creates a high risk of pine bark beetle infestation, pine is not to be cut during the period March 1 through July 1, unless all portions of trees greater than two inches in diameter are removed from the sale area, reduced to chips, or treated to the satisfaction of the Unit Manager or his/her representative, within fifteen days of being severed from the stump. Pine log decks, pulpwood piles and treetops that are piled for chipping in the fall or winter within a 1/4 mile of susceptible sites must be removed before March 15. Residual slash must not be placed in piles or rows and must be spread over the site for quick drying. The Department of Natural Resources will exercise this specification if the risk of damage warrants.

#### 5.2.4 - Dead and Down Creation

##### 5.2.4.4 - Dead and down creation, grouse (6/18)

To encourage grouse and other wildlife, in Payment Unit(s) 2, leave a total of six 12" or larger diameter (or largest diameter trees within stand) whole trees on the ground, preferably hardwood species such as oak or maple or if no hardwoods are present, pine species (white or red). These will be evenly scattered throughout the portions of the Payment Unit labeled "A6" and "A5" on the Timber Sale Map.

#### 5.2.29 - Shrub protection (1/20)

Reasonable care should be taken to avoid cutting or damaging hawthorn or junberry. These woody-shrub plants are highly beneficial to various wildlife species.

#### 5.2.32 - Decking/landing restoration (9/13)

All decking and landing areas must have the surface area restored to a condition equal to or better than before. This is to ensure the proper regeneration of the stand. Wood debris, chips and "cookies" from trimmings must be removed or scattered away from landing and loading areas and may not be windrowed on the edge.

#### 5.2.38 - No decking against live trees (2/04)

Cut products may not be decked against unmarked or designated leave trees.

#### 5.2.41 - Snowmobile trail protection (9/11)

Lewiston Grade is a snowmobile trail and is shown on the Timber Sale Map. Do not cut or damage posts with orange trail markers or traffic control signs. If the trail is used, it must be maintained and restored to a condition equal to or better than before the sale. If the trail is used for hauling, it must be graded to the satisfaction of the Unit Manager or his/her representative prior to December 1. If the trail road is to be used for hauling during the snowmobile season, then a snow-covered base must be left on the trail. The snowmobile trail is not to be used without written approval from the Unit

Manager. The snowmobile trail may only be crossed at right angles. Maintain a 20-foot-wide slash, debris, and rut free zone daily using the snowmobile trail as the centerline. No decking of forest products will be permitted along the snowmobile trail. All stumps within 20 feet of the snowmobile trail must be cut at ground level.

## **6 - Safety and Fire Prevention**

### **6.2 - Signing**

#### **6.2.1 - Road posting (10/20)**

The Purchaser is responsible for posting and maintaining caution signs on Wilcox Bridge Road and Lewiston Grade prior to beginning operations. The road must be posted at appropriate distances from the Sale Area to warn of logging activity and truck traffic. Signs must be removed when harvest operations are suspended or completed. The Purchaser will provide these signs.

## **7 - Other Conditions**

### **7.10 - Certified Timber**

#### **7.10.1 - Non-certified timber (2/16)**

The area encompassed by this timber sale is not certified to the standards of the Forest Stewardship Council (FSC) or the Sustainable Forestry Initiative (SFI). Forest products from this sale may not be delivered to the mill as "FSC and / or SFI certified". The lands within this sale are managed for military training.

**TIMBER SALE MAP**

This information provided by authority of Part 525, 1994 PA 451, as amended.

Sale Number  
**72-011-23**Date  
**08/14/2023**

Forest Management Unit		County	Mapped By: Scott McClarren	Scale 1:7,920	Page 1	Of 1
Grayling Mgt Unit		Crawford	Cruised By: Scott McClarren			
Township 27N	Range 03W	Section(s) and Subdivision(s)	Sec. 21 W1/2SW,NWSE;			

**Cover Type**

A = Aspen	J = Jack Pine	O = Oak	U = Upland Brush
B = Paper Birch	K = Rock	P = Lowland Poplar	UM = Upland Mix Forest
C = Cedar	L = Lowland Brush	Q = Mixed Swamp Conifer	V = Bog or Marsh
D = Treed Bog	LM = Lowland Mix Forest	R = Red Pine	W = White Pine
E = Swamp Hardwoods	M = Maple, Beech, Birch	S = Black Spruce	X = Non Stocked
F = Spruce/Fir	MC = Mixed Conifer	T = Tamarack	Y = Sand
G = Grass	MD = Mixed Deciduous		Z = Water
H = Hemlock	N = Marsh		

**Density**

0 = Non Stocked	5 = Pole Timber Medium
1 = Seedling Sapling Poor	6 = Pole Timber Well
2 = Seedling Sapling Medium	7 = Saw Timber Poor
3 = Seedling Sapling Well	8 = Saw Timber Medium
4 = Pole Timber Poor	9 = Saw Timber Well

**Locator Map (1:200,000)**

13	18	17	16	15	14
24	19	20	2	22	23
25	30	29	28	27	26
36	31	32	33	34	35

**PU # Acres**

1	3.5
2	17.5
3	7.3

**Fast Map Pine****28.3 Acres**

0 0.13 0.25 0.5 Miles

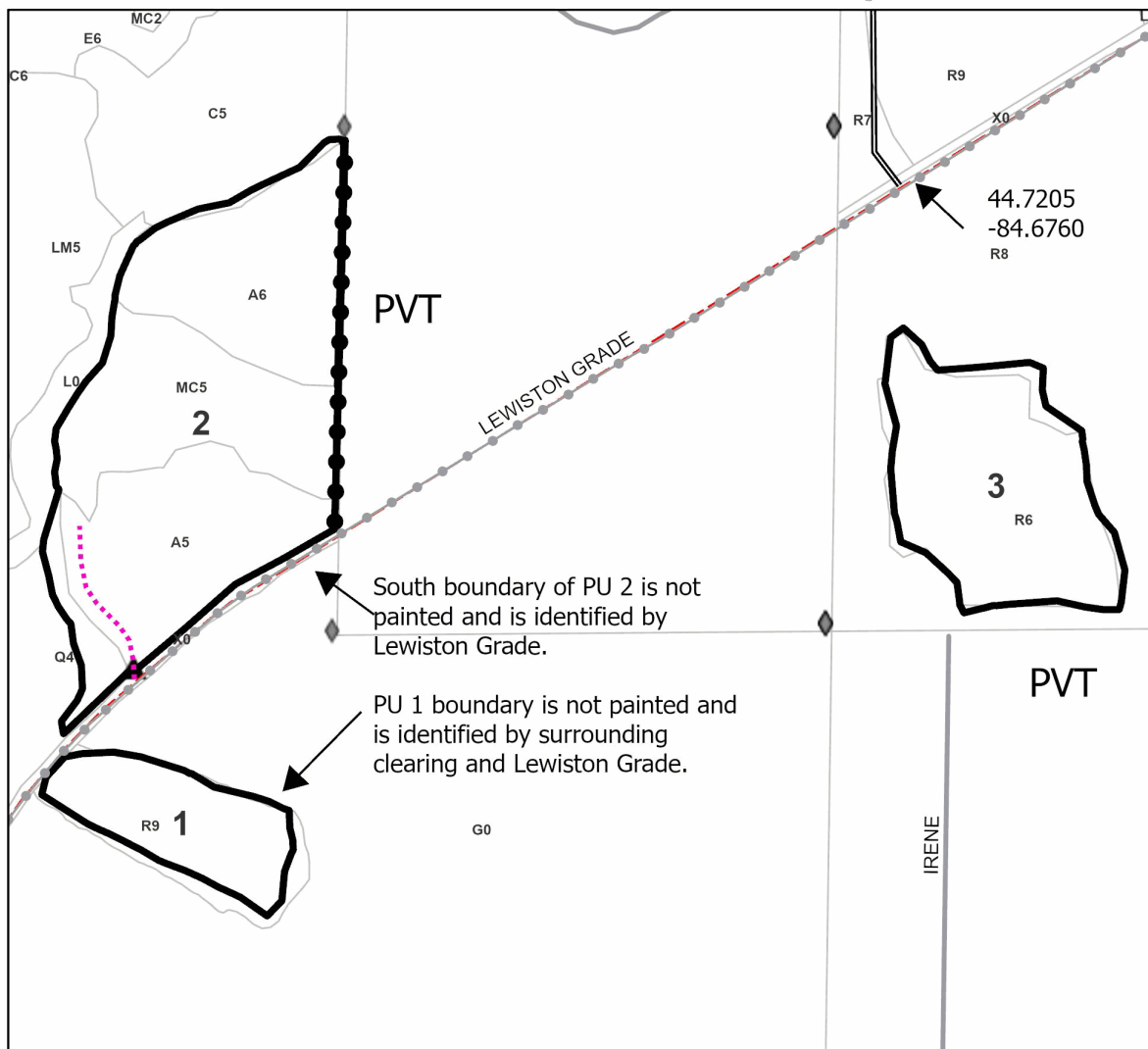
**Legend**

- Against State (Red or Unpainted)
- Private Line (Blue)
- Recreational Trail
- Primary Forest Road
- Secondary Forest Road
- Forest Access Route
- Paved Road
- Gravel Road
- County Road - Seasonal
- Private Road
- Temporary Management Access
- Field Grade Corner
- Berm
- Stand

Use QR Code to open Map in App

