



**DEPARTMENT OF NATURAL RESOURCES
STATE OF MICHIGAN
TIMBER SALE PROSPECTUS #7421**

SCHEDULED SALE DATE AND TIME: 2:00 p.m. (local time) on May 22, 2024.

LOCATION: SHINGLETON MGMT UNIT, PO BOX 67, M 28 WEST, SHINGLETON, MI 49884.

CONTACT NAME: Robert Burnham

PHONE NUMBER: (906) 420-1645

PROSPECTUS NOTE: The bidder is advised to inspect the sale area and review the location, estimated volumes, operating costs and contract terms of proposed sales. Please be aware that some landowners may request 60 days or more notice for access across their land.

Notice is hereby given that bids will be received by the Unit Manager, SHINGLETON MANAGEMENT UNIT, for certain timber on the following described lands:

Hagrids Hardwood (41-012-23) / T47N, R17W, SEC. 1 , SWNE,SW,NWSE.

T47N, R17W, SEC. 10, E1/2NW,NE.

T47N, R17W, SEC. 11, W1/2NW,W1/2SW.

T47N, R17W, SEC. 2 , NE,N1/2SE.

T47N, R17W, SEC. 3 , NW,W1/2NE,N1/2SW,SESW,SE.

T48N, R17W, SEC. 35, SESE.

Alger County, Advertised Price \$426,875.80, 443.0 Acres, Hardwood, Sugar Maple.

SALE NOTE: Road work is required on this sale. See Sale Spec 4.1.8.

The county must be contacted prior to crossing or harvesting in the county road R-O-W. This applies to Payment Units 5, 6, 9 and H-58.

Permission for access across private land is the responsibility of the Purchaser. See Sale Spec 4.4.1 for additional information.

Access may be through private land.

TIMBER SALE INFORMATION

Hagrids Hardwood (41-012-23)

T47N, R17W, SEC. 1; T47N, R17W, SEC. 10; T47N, R17W, SEC. 11; T47N, R17W, SEC. 2; T47N, R17W, SEC. 3; T48N, R17W, SEC. 35
Alger County (Advertised Price \$426,875.80)

SALE NOTE: Road work is required on this sale. See Sale Spec 4.1.8.

The county must be contacted prior to crossing or harvesting in the county road R-O-W. This applies to Payment Units 5, 6, 9 and H-58.

Permission for access across private land is the responsibility of the Purchaser. See Sale Spec 4.4.1 for additional information.

Access may be through private land.

A timber sale contract for this lump sum, sealed bid timber sale will be awarded to the responsible bidder offering the highest sealed bid price. All units of volume listed below were estimated using the Inventory Manager computer program and the new Michigan taper model. Bids must be at or above the following advertised price for each product and species:

<u>PRODUCTS & SPECIES</u>	<u>ESTIMATED UNITS*</u>	<u>ADVERTISED PRICE</u>
Sawtimber		
Basswood	51.9 MBF	\$ 119.00 / MBF
Black Cherry	31.6 MBF	\$ 98.00 / MBF
Paper Birch	47.2 MBF	\$ 86.00 / MBF
Red Maple	386.5 MBF	\$ 87.00 / MBF
Sugar Maple	767.7 MBF	\$ 349.00 / MBF
Yellow Birch	5.8 MBF	\$ 93.00 / MBF
Pulpwood		
Balsam Fir	201 Cords	\$ 13.50 / Cord
Basswood	28 Cords	\$ 8.10 / Cord
Mixed Aspen	13 Cords	\$ 29.20 / Cord
Mixed Hardwood	4,661 Cords	\$ 22.25 / Cord
Paper Birch	275 Cords	\$ 13.55 / Cord
White Spruce	39 Cords	\$ 17.90 / Cord

* The total volume is statistically estimated within plus (+) or minus (-) 6.71 percent. There are an estimated 8,544 cords on this timber sale, plus or minus 574 cords at the 95% confidence level. The estimated units are final and not subject to adjustment. Prospective bidders are urged to examine this timber and to make their own estimates of quantity and quality.

BOND AND PAYMENT SCHEDULE:

1. A bond in the amount of \$21,343.79 to insure faithful performance of the conditions of the contract will be deposited by the successful bidder within 21 days of the sale award.
2. Cutting in any sale or unit without the required advance payment would be considered a trespass.
3. Total payment must be paid in advance or according to the following schedule :
 - (a) Ten percent (10%) of the sale value must be paid within 21 days of the sale award.
 - (b) The 10% down payment will be credited towards the first unit cut.
 - (c) Payment for each of the following units must be made before cutting begins in that unit:

<u>PAYMENT UNIT NUMBER</u>	<u>PERCENT OF TOTAL SALE VALUE</u>
01	6.9%
02	9.2%
03	3.3%
04	5.1%
05	5.3%
06	2.0%
07	2.4%
08	6.5%
09	3.4%
10	3.1%
11	14.3%
12	8.9%
13	12.2%
14	12.7%
15	3.8%
16	0.9%

4. If no cutting takes place, the 10% down payment will not be refunded.
5. Operations on the contract issued will terminate on 06/30/2028.

SALE STATISTICS

Volumes were calculated in cubic feet using the Michigan taper model. Cubic foot volume includes all wood inside bark for the product indicated. For display purposes, cubic feet were converted to cords and MBF using a simple conversion factor, e.g. 79 cubic feet per cord and 185 cubic feet per MBF. The cubic foot volumes are precise; the cords and MBF volumes are not. Cubic foot volume cannot be directly converted to cords or boards with precision.

SALE VOLUMES

The total estimated sale volume may not equal the sum of the species/products due to the nature of statistical calculations associated with double sampling methodology.

VOLUME			STATISTICAL RANGE IN CORDS	
TOTAL CUBIC FEET	TOTAL CORDS	PERCENT ERROR	MINIMUM	MAXIMUM
674,983	8,544	6.71%	7,970	9,118

VDU VOLUMES

A VDU is a Volume Determination Unit. Volumes and their associated statistics are calculated at the VDU level and summarized to the sale level. There is often a one to one relationship between a VDU and a Payment Unit, but not always, depending on the cruise design. Refer to the VDU TO PAYMENT UNIT table.

	VOLUME			RANGE IN CORDS	
VDU	TOTAL CUBIC FEET	TOTAL CORDS	PERCENT ERROR	MINIMUM	MAXIMUM
1	233,501	2,956	9.44%	2,677	3,235
2	293,267	3,712	9.38%	3,364	4,060
3	65,018	823	13.53%	712	934
4	69,024	874	14.12%	750	997
5	14,174	179	56.12%	79	280
TOTAL:	674,983	8,544		7,582	9,507

VDU TO PAYMENT UNIT

When a VDU is associated with more than one Payment Unit (PU), the VDU volumes are assigned to the PU based on acres of the VDU within the PU.

VDU	VDU ACRES	PU	PU ACRES
1	167.9	1	36.4
		2	48.7
		3	17.3
		4	27.1
		5	28.0
		6	10.4
2	217.9	7	9.8
		10	12.4
		11	58.5
		12	36.0
		13	49.6
		14	51.6
3	33.1	8	21.8
		9	11.3
4	19.2	15	19.2
5	4.9	16	4.9
TOTAL:	443.0		443.0

DESCRIPTION OF TIMBER BY PU (PU)

PU	MARKET GROUP	PRODUCT	QUANTITY	UNIT	ACRES	ADVERTISE PRICE
1	Black Cherry	Sawtimber	6.0	MBF	36.4	\$29,321.15
	Red Maple		37.5	MBF		
	Sugar Maple		46.9	MBF		
	Balsam Fir	Pulpwood	14	Cords		
	Mixed Hardwood		399	Cords		
	<i>Beech</i>		38	<i>Cords</i>		
	<i>Black Cherry</i>		15	<i>Cords</i>		
	<i>Red Maple</i>		151	<i>Cords</i>		
	<i>Sugar Maple</i>		195	<i>Cords</i>		
	White Spruce		2	Cords		
2	Black Cherry	Sawtimber	8.0	MBF	48.7	\$39,265.15
	Red Maple		50.0	MBF		
	Sugar Maple		62.8	MBF		
	Balsam Fir	Pulpwood	19	Cords		
	Mixed Hardwood		535	Cords		
	<i>Beech</i>		50	<i>Cords</i>		
	<i>Black Cherry</i>		21	<i>Cords</i>		
	<i>Red Maple</i>		203	<i>Cords</i>		
	<i>Sugar Maple</i>		261	<i>Cords</i>		
	White Spruce		3	Cords		
3	Black Cherry	Sawtimber	2.8	MBF	17.3	\$13,945.60
	Red Maple		17.8	MBF		
	Sugar Maple		22.3	MBF		
	Balsam Fir	Pulpwood	7	Cords		
	Mixed Hardwood		190	Cords		
	<i>Beech</i>		18	<i>Cords</i>		
	<i>Black Cherry</i>		7	<i>Cords</i>		
	<i>Red Maple</i>		72	<i>Cords</i>		
	<i>Sugar Maple</i>		93	<i>Cords</i>		
	White Spruce		1	Cords		
4	Black Cherry	Sawtimber	4.5	MBF	27.1	\$21,840.95
	Red Maple		27.9	MBF		
	Sugar Maple		34.9	MBF		
	Balsam Fir	Pulpwood	11	Cords		
	Mixed Hardwood		297	Cords		
	<i>Beech</i>		28	<i>Cords</i>		
	<i>Black Cherry</i>		11	<i>Cords</i>		
	<i>Red Maple</i>		113	<i>Cords</i>		
	<i>Sugar Maple</i>		145	<i>Cords</i>		
	White Spruce		2	Cords		
5	Black Cherry	Sawtimber	4.6	MBF	28.0	\$22,570.35
	Red Maple		28.8	MBF		
	Sugar Maple		36.1	MBF		
	Balsam Fir	Pulpwood	11	Cords		
	Mixed Hardwood		307	Cords		
	<i>Beech</i>		29	<i>Cords</i>		
	<i>Black Cherry</i>		12	<i>Cords</i>		
	<i>Red Maple</i>		116	<i>Cords</i>		
	<i>Sugar Maple</i>		150	<i>Cords</i>		
	White Spruce		2	Cords		
6	Black Cherry	Sawtimber	1.7	MBF	10.4	\$8,382.50
	Red Maple		10.7	MBF		
	Sugar Maple		13.4	MBF		
	Balsam Fir	Pulpwood	4	Cords		

DESCRIPTION OF TIMBER BY PU (PU), CON'T

PU	MARKET GROUP	PRODUCT	QUANTITY	UNIT	ACRES	ADVERTISE PRICE
6 con't	Mixed Hardwood	Pulpwood	114	Cords		
	<i>Beech</i>		11	<i>Cords</i>		
	<i>Black Cherry</i>		4	<i>Cords</i>		
	<i>Red Maple</i>		43	<i>Cords</i>		
	<i>Sugar Maple</i>		56	<i>Cords</i>		
	White Spruce		1	Cords		
7	Basswood	Sawtimber	1.2	MBF	9.8	\$10,346.80
	Black Cherry		0.2	MBF		
	Paper Birch		0.1	MBF		
	Red Maple		7.0	MBF		
	Sugar Maple		21.4	MBF		
	Balsam Fir	Pulpwood	3	Cords		
	Basswood		1	Cords		
	Mixed Aspen		1	Cords		
	<i>Quaking Aspen</i>		1	<i>Cords</i>		
	Mixed Hardwood		90	Cords		
	<i>Beech</i>		21	<i>Cords</i>		
	<i>Black Cherry</i>		1	<i>Cords</i>		
	<i>Red Maple</i>		17	<i>Cords</i>		
	<i>Sugar Maple</i>		51	<i>Cords</i>		
	White Spruce		1	Cords		
8	Basswood	Sawtimber	16.7	MBF	21.8	\$27,728.10
	Red Maple		11.5	MBF		
	Sugar Maple		49.5	MBF		
	Balsam Fir	Pulpwood	7	Cords		
	Basswood		10	Cords		
	Mixed Hardwood		326	Cords		
	<i>Beech</i>		3	<i>Cords</i>		
	<i>Red Maple</i>		38	<i>Cords</i>		
	<i>Sugar Maple</i>		285	<i>Cords</i>		
	White Spruce		2	Cords		
9	Basswood	Sawtimber	8.7	MBF	11.3	\$14,363.50
	Red Maple		6.0	MBF		
	Sugar Maple		25.7	MBF		
	Balsam Fir	Pulpwood	3	Cords		
	Basswood		5	Cords		
	Mixed Hardwood		168	Cords		
	<i>Beech</i>		1	<i>Cords</i>		
	<i>Red Maple</i>		19	<i>Cords</i>		
	<i>Sugar Maple</i>		148	<i>Cords</i>		
	White Spruce		1	Cords		
10	Basswood	Sawtimber	1.5	MBF	12.4	\$13,040.15
	Black Cherry		0.2	MBF		
	Paper Birch		0.1	MBF		
	Red Maple		8.8	MBF		
	Sugar Maple		27.1	MBF		
	Balsam Fir	Pulpwood	3	Cords		
	Basswood		1	Cords		
	Mixed Aspen		1	Cords		
	<i>Quaking Aspen</i>		1	<i>Cords</i>		
	Mixed Hardwood		113	Cords		
	<i>Beech</i>		26	<i>Cords</i>		
	<i>Black Cherry</i>		1	<i>Cords</i>		
	<i>Red Maple</i>		21	<i>Cords</i>		
	<i>Sugar Maple</i>		65	<i>Cords</i>		

DESCRIPTION OF TIMBER BY PU (PU), CON'T

PU	MARKET GROUP	PRODUCT	QUANTITY	UNIT	ACRES	ADVERTISE PRICE
10 con't	White Spruce	Pulpwood	1	Cords		
11	Basswood	Sawtimber	7.1	MBF	58.5	\$61,587.30
	Black Cherry		1.1	MBF		
	Paper Birch		0.4	MBF		
	Red Maple		41.6	MBF		
	Sugar Maple		127.9	MBF		
	Balsam Fir	Pulpwood	16	Cords		
	Basswood		3	Cords		
	Mixed Aspen		3	Cords		
	<i>Quaking Aspen</i>		3	Cords		
	Mixed Hardwood		534	Cords		
	<i>Beech</i>		123	Cords		
	<i>Black Cherry</i>		5	Cords		
	<i>Red Maple</i>		99	Cords		
	<i>Sugar Maple</i>		306	Cords		
	<i>Yellow Birch</i>		1	Cords		
	Paper Birch		2	Cords		
	White Spruce		6	Cords		
12	Basswood	Sawtimber	4.4	MBF	36.0	\$37,905.25
	Black Cherry		0.7	MBF		
	Paper Birch		0.2	MBF		
	Red Maple		25.6	MBF		
	Sugar Maple		78.6	MBF		
	Balsam Fir	Pulpwood	10	Cords		
	Basswood		2	Cords		
	Mixed Aspen		2	Cords		
	<i>Quaking Aspen</i>		2	Cords		
	Mixed Hardwood		330	Cords		
	<i>Beech</i>		76	Cords		
	<i>Black Cherry</i>		3	Cords		
	<i>Red Maple</i>		61	Cords		
	<i>Sugar Maple</i>		189	Cords		
	<i>Yellow Birch</i>		1	Cords		
	Paper Birch		1	Cords		
	White Spruce		4	Cords		
13	Basswood	Sawtimber	6.0	MBF	49.6	\$52,213.95
	Black Cherry		0.9	MBF		
	Paper Birch		0.3	MBF		
	Red Maple		35.2	MBF		
	Sugar Maple		108.4	MBF		
	Balsam Fir	Pulpwood	13	Cords		
	Basswood		3	Cords		
	Mixed Aspen		3	Cords		
	<i>Quaking Aspen</i>		3	Cords		
	Mixed Hardwood		454	Cords		
	<i>Beech</i>		105	Cords		
	<i>Black Cherry</i>		4	Cords		
	<i>Red Maple</i>		84	Cords		
	<i>Sugar Maple</i>		260	Cords		
	<i>Yellow Birch</i>		1	Cords		
	Paper Birch		1	Cords		
	White Spruce		5	Cords		
14	Basswood	Sawtimber	6.3	MBF	51.6	\$54,294.85
	Black Cherry		0.9	MBF		
	Paper Birch		0.3	MBF		

DESCRIPTION OF TIMBER BY PU (PU), CON'T

PU	MARKET GROUP	PRODUCT	QUANTITY	UNIT	ACRES	ADVERTISE PRICE
14 cont	Red Maple	Sawtimber	36.7	MBF		
	Sugar Maple		112.7	MBF		
	Balsam Fir	Pulpwood	14	Cords		
	Basswood		3	Cords		
	Mixed Aspen		3	Cords		
	<i>Quaking Aspen</i>		3	<i>Cords</i>		
	Mixed Hardwood		472	Cords		
	<i>Beech</i>		109	<i>Cords</i>		
	<i>Black Cherry</i>		4	<i>Cords</i>		
	<i>Red Maple</i>		88	<i>Cords</i>		
	<i>Sugar Maple</i>		270	<i>Cords</i>		
	<i>Yellow Birch</i>		1	<i>Cords</i>		
	Paper Birch		1	Cords		
	White Spruce		5	Cords		
15	Paper Birch	Sawtimber	45.8	MBF	19.2	\$16,226.25
	Red Maple		31.2	MBF		
	Yellow Birch		3.7	MBF		
	Balsam Fir	Pulpwood	51	Cords		
	Mixed Hardwood		217	Cords		
	<i>Black Ash</i>		2	<i>Cords</i>		
	<i>Red Maple</i>		141	<i>Cords</i>		
	<i>Sugar Maple</i>		20	<i>Cords</i>		
	<i>Yellow Birch</i>		54	<i>Cords</i>		
	Paper Birch		270	Cords		
	White Spruce		3	Cords		
	16	Red Maple	Sawtimber	10.2		
Yellow Birch			2.1	MBF		
Balsam Fir		Pulpwood	15	Cords		
Mixed Hardwood			115	Cords		
<i>Red Maple</i>			109	<i>Cords</i>		
<i>Yellow Birch</i>			6	<i>Cords</i>		
TOTAL:			1,290.7	MBF		
TOTAL:			5,217	Cords		

Sale Specific Conditions & Requirements

Sale Name: Hagrids Hardwood

Sale Number: 41-012-23 Seq#: 2

1 - Sale Area

1.2 - Boundaries

1.2.1 - Painted boundaries (9/19)

The sale boundary and Payment Unit boundaries are marked and identified by blue, red and yellow paint. Exterior sale boundary lines against private property are marked with blue paint. Exterior sale boundary lines against state are marked with red paint. Interior Payment Unit boundaries are marked with yellow paint. The painted boundary line trees are not Included Timber and are to be protected unless marked with orange paint.

2 - Timber Specifications

2.1 - Included Timber

2.1.2 - Clearcut unit(s) w/o unmerchantable trees (8/11)

Within Payment Unit(s) 15 & 16, cut all trees which meet minimum piece specifications in 2.2 Utilization, except do not cut any hemlock or cedar. Special protection trees identified in accordance with condition 3.4.2, within clearcutting unit boundaries, are not Included Timber and are to be protected.

2.1.3 - Cut tree marked unit(s) (12/08)

Within Payment Unit(s) 1-9 & 12-14, all trees are designated for cutting when marked with orange paint above and below stump height, regardless of merchantability.

Within Payment Units 10 & 11, all trees are designated for cutting when marked with purple paint above and below stump height, regardless of merchantability. Trees marked with orange paint within Payment Units 10 & 11 are to be left uncut, unless also marked with purple paint.

2.2 - Utilization

2.2.10 - No chipping tops and limbs (8/16)

Within Payment Unit(s) 1-16, chipping of the bole, 2-inches in diameter or greater, is allowed. Chipping of limbs or portions of the tree less than 2-inches in diameter is not permitted. Limbs and the remaining top must be left on site and scattered.

3 - Payments

3.3 - Pre-measured Sales

3.3.4 - Dividing payment units (7/14)

Payment Unit(s) that are \$20,000 or greater in value, may be divided at the request of the Purchaser and upon approval of the Unit Manager. Dividing Payment Units is a contract modification which requires a Timber Sale Contract Amendment.

3.4 - Damaged Timber

3.4.2 - Special Protection Trees (4/14)

The Purchaser shall not cut live or dead special protection trees within cutting units or clearings. Special protection trees are hemlock and oak. If the Purchaser's operations have cut or damaged special protection trees through carelessness, the Purchaser shall pay \$100 as fixed, agreed and liquidated damages for each special protection tree cut or damaged. Such payment does not constitute ownership of the undesignated timber.

4 - Transportation

4.1 - Construction

4.1.3 - Slash and earthen piles (8/04)

Piles or windrows of earth along roads and landings that have been widened or constructed shall be leveled. Slash from road maintenance or construction, including stumps, shall be dispersed throughout the sale.

4.1.6 - Road construction (1/09)

Construction of new roads or improvements of existing roads shall be done in such a way as to minimize the environmental and visual impacts. Merchantable trees shall be cut and utilized unless otherwise directed. Non-merchantable trees shall be severed and laid flat on the ground. Slash shall be scattered, and not left in windrows and kept a minimum of 10 feet back from the road edge. Stumps shall be set upright, not left on edge, and be moved at least 10 feet away from the road edge. Disturbed soil shall be feathered into the woods and not left in berms or windrows.

4.1.7 - Road closure (10/11)

All new roads built into the sale must be blocked to vehicle traffic upon completion of the sale. Overgrown roads that are reopened shall be considered new roads. In general, this will require constructing a four (4') foot high berm of stumps and logs covered with earth. Stumps and brush must be placed along the remainder of the trail. These roads must be rendered impassable to cars and trucks. All stumps from road building and landing construction must be reserved to block any newly constructed roads upon completion of the sale. These stumps must be scattered along the road system to prohibit vehicular movement. Contact the Sale Administrator for specific details of design and placement.

4.1.8 - Road work (1) (8/07)

The following road work is required: 300 cubic yards of 3" minus gravel must be purchased, hauled and spread by the purchaser. The road work will be determined at the Pre-Sale meeting and must be placed before hauling can begin.

4.1.10 - Oversight (12/08)

The Unit Manager, or his/her representative, must be present when the road improvement project is initiated.

4.2 - Maintenance

4.2.4 - Grading (10/16)

For completion of the sale, state forest roads must be graded. In general, this will require a road grader or bulldozer to shape up the roads after forest products have been hauled off site. This includes cleaning of drainage areas, grading, crowning and filling with gravel, if necessary. The grading equipment to be used must be approved by the Unit Manager or his/her representative.

4.3 - Public Right-of-Way

4.3.2 - County R-O-W (12/06)

The county must be contacted prior to crossing or harvesting in the county road R-O-W. This applies to Payment Units 5, 6, 9, and Highway H-58.

4.4 - Access

4.4.1 - Private property access (3/11)

Permission for access across private land is the responsibility of the Purchaser. If crossing Manulife Management Property, a permit is required. When the sale is purchased, they should be contacted about crossing their property. Allow 30-60 days for permit processing. A copy of the permit should be provided to the Unit Manager by the pre-sale conference.

5 - Operations

5.2 - Conduct of Operations

5.2.2 - Hazard Trees/Snags

5.2.2.1 - Den trees (10/16)

Obvious hollow and/or den trees shall be protected and left standing unless they are a safety hazard.

5.2.3 - Operating Restrictions

5.2.3.3 - Bark slippage restriction (3/09)

Within Payment Unit(s) 1-14, unless changed by written agreement, cutting and skidding are not permitted during the period of April 15 to July 15. This restriction is because of bark slippage.

5.2.32 - Decking/landing restoration (9/13)

All decking and landing areas must have the surface area restored to a condition equal to or better than before. This is to ensure the proper regeneration of the stand. Wood debris, chips and "cookies" from trimmings must be removed or scattered

away from landing and loading areas and may not be windrowed on the edge.

5.2.38 - No decking against live trees (2/04)

Cut products may not be decked against unmarked or designated leave trees.

5.4 - Soil Protection

5.4.6 - Wet area protection (5/10)

No harvesting operations, including skidding and felling, are to take place within the vernal pond in Payment Unit 2. The vernal pond is excluded with red paint. Care must be taken by the Purchaser to identify and avoid operating in these areas of the timber sale.

5.8 - Protection of Endangered Species

5.8.3 - Red shoulder hawk or goshawk (1) (2/16)

In the event that an active red shoulder hawk or goshawk nest is found, the contract may be amended to protect the nest site until the nest is determined to be inactive. The value of the trees in this excluded area will be refunded or credited to the Purchaser. The nest will be buffered with a five-chain radius (eight acre) protection area, centered on the nest tree, in which there will be no cutting or new roads constructed. Avoid human disturbance, including loading and skidding, in the protection area.

An additional zone of five chains (ten chains centered on the active nest tree) will be established in which there is no management activity from April 1 to July 30. Limit biomass harvesting and chipping operations within this ten-chain zone, retain the maximum one-third of residues per the Woody Biomass Harvesting Guidelines (Michigan DNR 2010). Nests determined to be inactive will be protected with a one-chain no-harvest buffer.

6 - Safety and Fire Prevention

6.2 - Signing

6.2.1 - Road posting (10/20)

The Purchaser is responsible for posting and maintaining caution signs on Highway H-58 prior to beginning operations. The road must be posted at appropriate distances from the Sale Area to warn of logging activity and truck traffic. Signs must be removed when harvest operations are suspended or completed. The Purchaser will provide these signs.

**TIMBER SALE MAP**

This information provided by authority of Part 525, 1994 PA 451, as amended.

Sale Number
41-012-23Date
02/23/2024

Forest Management Unit

County

Mapped By: Kentner

Scale

Page

Of

Shingleton Mgt Unit

Alger

Cruised By: UMLM

1:15,840

1

2

Township
47N / 48NRange
17WSection(s) and Subdivision(s) 3 NW,W1/2NE,N1/2SW,SESW,SE; Sec. 35 SESE;
Sec. 1 SWNE,SW,NWSE; Sec. 10 E1/2NW,NE; Sec. 11 W1/2NW,W1/2SW; Sec. 2 NE,N1/2SE; Sec.**Cover Type**

A = Aspen	J = Jack Pine	O = Oak	U = Upland Brush
B = Paper Birch	K = Rock	P = Lowland Poplar	UM = Upland Mix Forest
C = Cedar	L = Lowland Brush	Q = Mixed Swamp Conifer	V = Bog or Marsh
D = Treed Bog	LM = Lowland Mix Forest	R = Red Pine	W = White Pine
E = Swamp Hardwoods	M = Maple, Beech, Birch	S = Black Spruce	X = Non Stocked
F = Spruce/Fir	MC = Mixed Conifer	T = Tamarack	Y = Sand
G = Grass	MD = Mixed Deciduous		Z = Water
H = Hemlock	N = Marsh		

Density

0 = Non Stocked	5 = Pole Timber Medium
1 = Seedling Sapling Poor	6 = Pole Timber Well
2 = Seedling Sapling Medium	7 = Saw Timber Poor
3 = Seedling Sapling Well	8 = Saw Timber Medium
4 = Pole Timber Poor	9 = Saw Timber Well

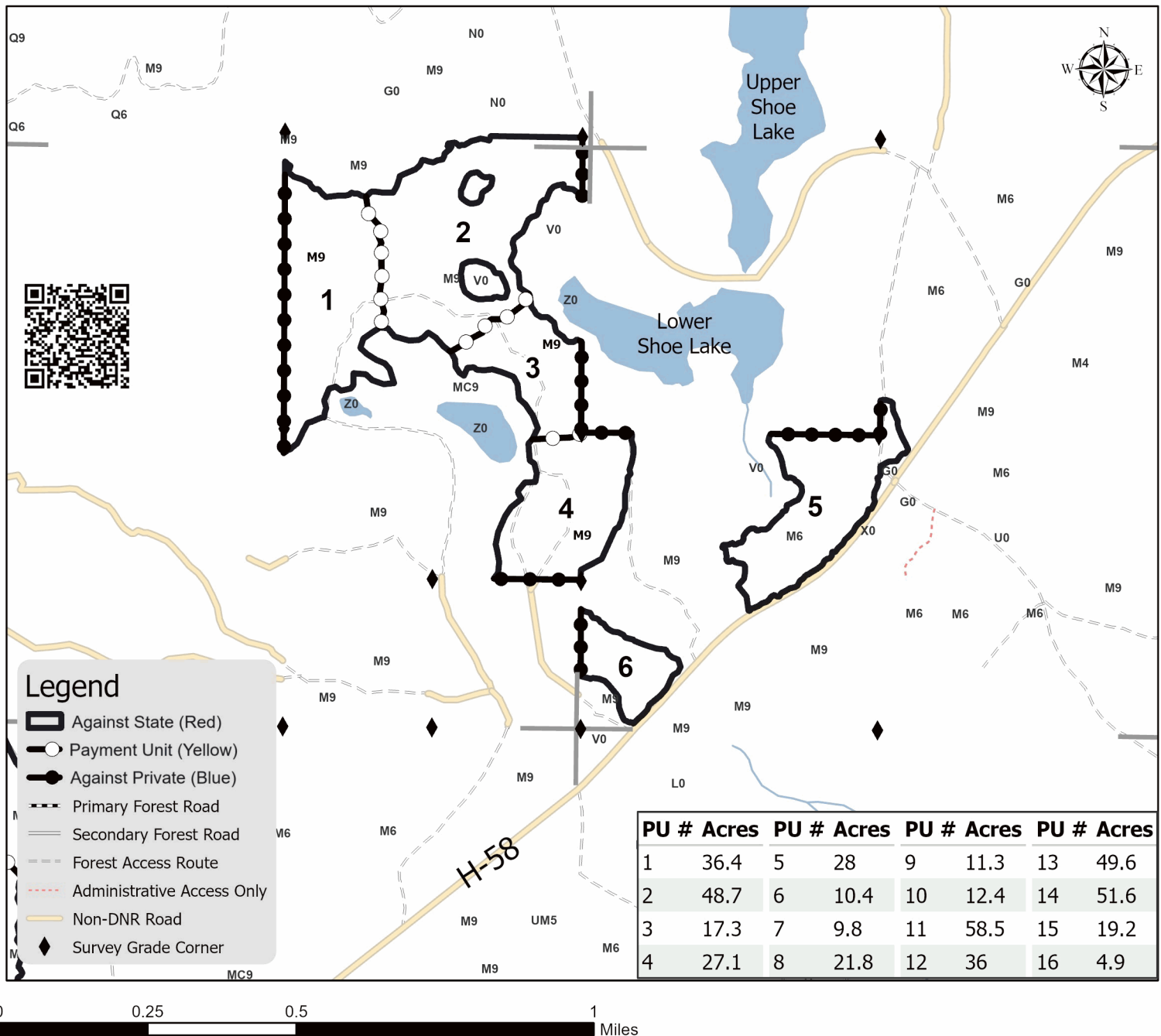
Hagrids Hardwood**443.0 Acres**

**TIMBER SALE MAP**

This information provided by authority of Part 525, 1994 PA 451, as amended.

Sale Number

41-012-23

Date

10/02/2023

Forest Management Unit

Shingleton Mgt Unit

County

Alger

Mapped By: Kentner

Cruised By: UMLM

Scale

1:20,000

Page

2

Of

2

Township

47N / 48N

Range

17W

Section(s) and 3 NW, W1/2NE, N1/2SW, SESW, SE; Sec. 35 SESE;

Subdivision(s) Sec. 1 SWNE, SW, NWSE; Sec. 10 E1/2NW, NE; Sec. 11 W1/2NW, W1/2SW; Sec. 2 NE, N1/2SE; Sec.

Cover Type

A = Aspen	J = Jack Pine	O = Oak	U = Upland Brush
B = Paper Birch	K = Rock	P = Lowland Poplar	UM = Upland Mix Forest
C = Cedar	L = Lowland Brush	Q = Mixed Swamp Conifer	V = Bog or Marsh
D = Treed Bog	LM = Lowland Mix Forest	R = Red Pine	W = White Pine
E = Swamp Hardwoods	M = Maple, Beech, Birch	S = Black Spruce	X = Non Stocked
F = Spruce/Fir	MC = Mixed Conifer	T = Tamarack	Y = Sand
G = Grass	MD = Mixed Deciduous		Z = Water
H = Hemlock	N = Marsh		

Density

0 = Non Stocked	5 = Pole Timber Medium
1 = Seedling Sapling Poor	6 = Pole Timber Well
2 = Seedling Sapling Medium	7 = Saw Timber Poor
3 = Seedling Sapling Well	8 = Saw Timber Medium
4 = Pole Timber Poor	9 = Saw Timber Well

Hagrids Hardwood**443.0 Acres**