



**DEPARTMENT OF NATURAL RESOURCES  
STATE OF MICHIGAN  
TIMBER SALE PROSPECTUS #7441**

**SCHEDULED SALE DATE AND TIME: 9:00 a.m. (local time) on May 14, 2024.**

**LOCATION: ROSCOMMON MGMT UNIT, PO BOX 218, ROSCOMMON, MI 48653.**

**CONTACT NAME: Jason Lewicki**

**PHONE NUMBER: (989) 745-5870**

**PROSPECTUS NOTE:** The bidder is advised to inspect the sale area and review the location, estimated volumes, operating costs and contract terms of proposed sales. Please be aware that some landowners may request 60 days or more notice for access across their land.

Notice is hereby given that bids will be received by the Unit Manager, ROSCOMMON MANAGEMENT UNIT, for certain timber on the following described lands:

Triangle Mix (71-004-24) / T24N, R03W, SEC. 1 , NWNW.

T24N, R03W, SEC. 11, NESE.

T24N, R03W, SEC. 12, SWSW.

T24N, R03W, SEC. 13, NENW.

T24N, R03W, SEC. 2 , SESW.

Roscommon County, Advertised Price \$36,817.05, 36.9 Acres, Aspen, Hardwood.

# TIMBER SALE INFORMATION

## Triangle Mix (71-004-24)

T24N, R03W, SEC. 1; T24N, R03W, SEC. 11; T24N, R03W, SEC. 12; T24N, R03W, SEC. 13; T24N, R03W, SEC. 2.  
Roscommon County (Advertised Price \$36,817.05)

A timber sale contract for this lump sum, sealed bid timber sale will be awarded to the responsible bidder offering the highest sealed bid price. All units of volume listed below were estimated using the Inventory Manager computer program and the new Michigan taper model. Bids must be at or above the following advertised price for each product and species:

<u>PRODUCTS &amp; SPECIES</u>	<u>ESTIMATED UNITS*</u>	<u>ADVERTISED PRICE</u>
Sawtimber		
Black/Red (Hybrid) Oak	71.0 MBF	\$ 131.00 / MBF
Mixed Aspen	54.9 MBF	\$ 88.00 / MBF
Red Maple	26.3 MBF	\$ 79.00 / MBF
White Oak	9.4 MBF	\$ 74.00 / MBF
Pulpwood		
Balsam Fir	104 Cords	\$ 27.10 / Cord
Jack Pine	40 Cords	\$ 12.25 / Cord
Mixed Aspen	216 Cords	\$ 39.35 / Cord
Mixed Oak	99 Cords	\$ 24.00 / Cord
Paper Birch	50 Cords	\$ 22.45 / Cord
Red Maple	137 Cords	\$ 24.55 / Cord
Red Pine	6 Cords	\$ 43.95 / Cord
White Pine	24 Cords	\$ 40.75 / Cord

\* The total volume is statistically estimated within plus (+) or minus (-) 41.16 percent. There are an estimated 1,060 cords on this timber sale, plus or minus 436 cords at the 95% confidence level. The estimated units are final and not subject to adjustment. Prospective bidders are urged to examine this timber and to make their own estimates of quantity and quality.

### **BOND AND PAYMENT SCHEDULE:**

- A bond in the amount of \$1,840.85 to insure faithful performance of the conditions of the contract will be deposited by the successful bidder within 21 days of the sale award.
- Cutting in any sale or unit without the required advance payment would be considered a trespass.
- Total payment must be paid in advance or according to the following schedule :
  - Ten percent (10%) of the sale value must be paid within 21 days of the sale award.
  - The 10% down payment will be credited towards the first unit cut.
  - Payment for each of the following units must be made before cutting begins in that unit:

PAYMENT UNIT NUMBER	PERCENT OF TOTAL SALE VALUE
01	54.6%
02	26.2%
03	5.5%
04	8.3%
05	5.4%

- If no cutting takes place, the 10% down payment will not be refunded.
- Operations on the contract issued will terminate on 03/31/2026.

### **SALE STATISTICS**

Volumes were calculated in cubic feet using the Michigan taper model. Cubic foot volume includes all wood inside bark for the product indicated. For display purposes, cubic feet were converted to cords and MBF using a simple conversion factor, e.g. 79 cubic feet per cord and 185 cubic feet per MBF. The cubic foot volumes are precise; the cords and MBF volumes are not. Cubic foot volume cannot be directly converted to cords or boards with precision.

### **SALE VOLUMES**

The total estimated sale volume may not equal the sum of the species/products due to the nature of statistical calculations associated with double sampling methodology.

VOLUME		STATISTICAL RANGE IN CORDS		
TOTAL CUBIC FEET	TOTAL CORDS	PERCENT ERROR	MINIMUM	MAXIMUM
83,701	1,060	41.16%	623	1,496

## VDU VOLUMES

A VDU is a Volume Determination Unit. Volumes and their associated statistics are calculated at the VDU level and summarized to the sale level. There is often a one to one relationship between a VDU and a Payment Unit, but not always, depending on the cruise design. Refer to the VDU TO PAYMENT UNIT table.

	VOLUME			RANGE IN CORDS	
VDU	TOTAL CUBIC FEET	TOTAL CORDS	PERCENT ERROR	MINIMUM	MAXIMUM
132	17,624	223	50.81%	110	336
138	4,328	55	70.21%	16	93
195	6,024	76	64.24%	27	125
203	49,443	626	34.65%	409	843
207	6,282	80	69.36%	24	135
<b>TOTAL:</b>	<b>83,701</b>	<b>1,060</b>		<b>587</b>	<b>1,532</b>

## VDU TO PAYMENT UNIT

When a VDU is associated with more than one Payment Unit (PU), the VDU volumes are assigned to the PU based on acres of the VDU within the PU.

VDU	VDU ACRES	PU	PU ACRES
132	13.9	2	13.9
138	3.4	3	3.4
195	3.5	5	3.5
203	13.1	1	13.1
207	3.0	4	3.0
<b>TOTAL:</b>	<b>36.9</b>		<b>36.9</b>

**DESCRIPTION OF TIMBER BY PU (PU)**

PU	MARKET GROUP	PRODUCT	QUANTITY	UNIT	ACRES	ADVERTISE PRICE
1	Black/Red (Hybrid	Sawtimber	3.3	MBF	13.1	\$20,085.40
	Mixed Aspen		41.5	MBF		
	<i>B. T. Aspen</i>		41.5	<i>MBF</i>		
	Red Maple		26.3	MBF		
	Balsam Fir	Pulpwood	93	Cords		
	Mixed Aspen		174	Cords		
	<i>B. T. Aspen</i>		174	<i>Cords</i>		
	Mixed Oak		6	Cords		
	/Red (Hybrid) Oak		6	<i>Cords</i>		
	Paper Birch		50	Cords		
	<i>Paper Birch</i>	<i>Sawtimber</i>	4.5	<i>MBF</i>		
	<i>Paper Birch</i>	<i>Pulpwood</i>	41	<i>Cords</i>		
	Red Maple		134	Cords		
2	Black/Red (Hybrid	Sawtimber	50.4	MBF	13.9	\$9,640.50
	White Oak		7.9	MBF		
	Balsam Fir	Pulpwood	5	Cords		
	Mixed Aspen		7	Cords		
	<i>B. T. Aspen</i>		7	<i>Cords</i>		
	Mixed Oak		58	Cords		
	/Red (Hybrid) Oak		32	<i>Cords</i>		
	<i>White Oak</i>		26	<i>Cords</i>		
	Red Maple		3	Cords		
	Red Pine		2	Cords		
	White Pine		12	Cords		
	<i>White Pine</i>	<i>Sawtimber</i>	2.3	<i>MBF</i>		
	<i>White Pine</i>	<i>Pulpwood</i>	7	<i>Cords</i>		
3	Black/Red (Hybrid	Sawtimber	7.6	MBF	3.4	\$2,035.75
	White Oak		1.5	MBF		
	Jack Pine	Pulpwood	5	Cords		
	<i>Jack Pine</i>		5	<i>Cords</i>		
	Mixed Aspen		6	Cords		
	<i>B. T. Aspen</i>		6	<i>Cords</i>		
	Mixed Oak		19	Cords		
	/Red (Hybrid) Oak		14	<i>Cords</i>		
	<i>White Oak</i>		5	<i>Cords</i>		
	Red Pine		4	Cords		
4	Black/Red (Hybrid	Sawtimber	5.8	MBF	3.0	\$3,051.30
	Mixed Aspen		13.4	MBF		
	<i>B. T. Aspen</i>		9.2	<i>MBF</i>		
	<i>Quaking Aspen</i>		4.2	<i>MBF</i>		
	Jack Pine	Pulpwood	4	Cords		
	<i>Jack Pine</i>	<i>Sawtimber</i>	1.7	<i>MBF</i>		
	<i>Jack Pine</i>	<i>Pulpwood</i>	1	<i>Cords</i>		
	Mixed Aspen		18	Cords		
	<i>B. T. Aspen</i>		12	<i>Cords</i>		
	<i>Quaking Aspen</i>		6	<i>Cords</i>		
	Mixed Oak		8	Cords		
	/Red (Hybrid) Oak		8	<i>Cords</i>		
	White Pine		4	Cords		
	<i>White Pine</i>	<i>Sawtimber</i>	0.8	<i>MBF</i>		
	<i>White Pine</i>	<i>Pulpwood</i>	2	<i>Cords</i>		
5	Black/Red (Hybrid	Sawtimber	3.9	MBF	3.5	\$2,004.10
	Balsam Fir	Pulpwood	6	Cords		
	Jack Pine		31	Cords		
	<i>Jack Pine</i>	<i>Sawtimber</i>	7.0	<i>MBF</i>		

DESCRIPTION OF TIMBER BY PU (PU), CON'T

PU	MARKET GROUP	PRODUCT	QUANTITY	UNIT	ACRES	ADVERTISE PRICE
5 con't	<i>Jack Pine</i>	<i>Pulpwood</i>	<i>17</i>	<i>Cords</i>		
	Mixed Aspen		11	Cords		
	<i>B. T. Aspen</i>		<i>11</i>	<i>Cords</i>		
	Mixed Oak		8	Cords		
	<i>/Red (Hybrid) Oak</i>		<i>8</i>	<i>Cords</i>		
	White Pine		8	Cords		
	<i>White Pine</i>	<i>Sawtimber</i>	<i>1.6</i>	<i>MBF</i>		
	<i>White Pine</i>	<i>Pulpwood</i>	<i>5</i>	<i>Cords</i>		
TOTAL:			161.6	MBF		
TOTAL:			676	Cords		

## **Sale Specific Conditions & Requirements**

**Sale Name: Triangle Mix**

**Sale Number: 71-004-24 Seq#: 2**

### **1 - Sale Area**

#### **1.2 - Boundaries**

##### **1.2.1 - Painted boundaries (9/19)**

The sale boundary and Payment Unit boundaries are marked and identified by blue and red paint. Exterior sale boundary lines against private property are marked with blue paint. Exterior sale boundary lines against state are marked with red paint. Retention patches are marked with red paint; no harvesting activities may occur within these areas. The painted boundary line trees are not Included Timber and are to be protected.

### **2 - Timber Specifications**

#### **2.1 - Included Timber**

##### **2.1.1 - Clearcut unit(s) with unmerchantable trees (6/14)**

Within Payment Unit(s) 1, 3, 4, & 5, cut all trees that are two (2) inches or more at DBH, except in Payment Unit 3, do not cut any white oak & white pine that are fourteen (14) inches or more at DBH, and in Payment Unit 5 do not cut any white oak that are fourteen (14) inches or more at DBH.

##### **2.1.5 - Overstory removal unit(s) (8/11)**

Within Payment Unit(s) 2, all trees with a DBH equal to or greater than 5 inches which meet minimum piece specifications in 2.2 Utilization, are designated for cutting, except do not cut any trees marked with green paint.

#### **2.2 - Utilization**

##### **2.2.3 - Stump heights (4/07)**

Stump heights within the Sale Area shall not exceed 12 inches for trees greater than 10 inches DBH and 4 inches for trees smaller than 10 inches DBH.

##### **2.2.6 - Roundwood operation required (3/21)**

The skidding of whole trees or tree segments with limbs attached is prohibited within Payment Unit 2. All products must be produced as roundwood and forwarded to existing roads or landing areas in final product length.

### **3 - Payments**

#### **3.3 - Pre-measured Sales**

##### **3.3.4 - Dividing payment units (7/14)**

Payment Unit(s) 1 & 2 may be divided at the request of the Purchaser and upon approval of the Unit Manager. Dividing Payment Units is a contract modification which requires a Timber Sale Contract Amendment.

#### **3.4 - Damaged Timber**

##### **3.4.1 - Damaged timber (7/16)**

General Condition and Requirement 3.4 Damaged Timber, defines liquidated damages for undesignated live merchantable trees which are cut or injured. In addition, extreme care should be taken to avoid damage to tree seedlings and saplings. Within all Payment Units, if chipping does occur in a Payment Unit, it must be done before sprouting of new regeneration. If more than 33% of the newly sprouted tree seedlings within a specified portion of the Sale Area are damaged, liquidated damages will be assessed at \$300 per acre for all acreage within that specified portion of the Sale Area that was damaged. Within Payment Unit 2, if more than 33% of the tree seedlings or saplings (1/4" to 4.5" DBH) within a specified portion of the Sale Area are damaged, liquidated damages will be assessed at \$300 per acre for all acreage within that specified portion of the Sale Area that was damaged.

### **4 - Transportation**

#### **4.1 - Construction**

#### 4.1.6 - Road construction (1/09)

Construction of new roads or improvements of existing roads shall be done in such a way as to minimize the environmental and visual impacts. Merchantable trees shall be cut and utilized unless otherwise directed. Non-merchantable trees shall be severed and laid flat on the ground. Slash shall be scattered, and not left in windrows and kept a minimum of 10 feet back from the road edge. Stumps shall be set upright, not left on edge, and be moved at least 10 feet away from the road edge. Disturbed soil shall be feathered into the woods and not left in berms or windrows.

#### 4.1.7 - Road closure (10/11)

All new roads built into the sale must be blocked to vehicle traffic upon completion of the sale. Overgrown roads that are reopened shall be considered new roads. In general, this will require constructing a four (4') foot high berm of stumps and logs covered with earth. These roads must be rendered impassable to cars and trucks. All stumps from road building and landing construction must be reserved to block any newly constructed roads upon completion of the sale. Contact the Sale Administrator for specific details of design and placement.

### 4.2 - Maintenance

#### 4.2.5 - Two wheel drive condition (2/04)

All existing trail roads on and adjacent to the sale area must be passable by two-wheel drive traffic for the duration of the sale.

## 5 - Operations

### 5.1 - Notification

#### 5.1.1 - Pre-sale conference (10/16)

A pre-sale conference on site between the Purchaser and sale administrator is required prior to beginning any operations to determine landing and road locations. The Unit Manager or his/her representative must be contacted in advance to schedule the conference.

#### 5.1.4 - Post-sale conference (10/16)

A post-sale conference on site between the Purchaser and sale administrator is required 5 days prior to the completion of active logging operations to determine clean-up and repair of landings, road edges, and the fulfillment of other contract specifications.

### 5.2 - Conduct of Operations

#### 5.2.1 - Slash

##### 5.2.1.8 - Slash height (12/08)

No slash or tree tops may exceed 24 inches in height. Slash and tops must be spread evenly throughout the Sale Area and not left in windrows.

#### 5.2.3 - Operating Restrictions

##### 5.2.3.5 - Oak wilt restriction (1/18)

Within the Sale Area, unless changed by written agreement, cutting, skidding, hauling within the sale and brushing of access roads to the sale are not permitted during the period of April 15 to July 15. Operations may be allowed if specific steps are taken to prevent damaging uncut oak during the high risk period. Those steps may include completing all road brushing before April 15th and clearing a tree-length buffer along uncut oak cover before April 15th. This is necessary to reduce the spread of oak wilt. For more information, contact the Unit Manager or his/her representative.

##### 5.2.3.11 - Coppice regeneration protection (4/10)

Timber harvesting in any Payment Unit must be completed before significant aspen sprouting occurs in that Payment Unit to minimize damage to the new regeneration. Any post harvest operations, such as chipping, must be completed before sprouting of regeneration occurs. Should damages occur to the new regeneration, the damages will be assessed per sale condition 3.4.1. If it is anticipated that chipping will be delayed, then tops shall be carried to one central location, preferably the landing. A third party entity may be brought in to chip the tops/slash, before new sprouting occurs, should the contract holder fail to present in a timely manner arrangements approved by the DNR for protecting the new regeneration. The Unit Manager or his/her representative may also cease such operations if sprouting occurs before the operation is complete and the Payment Unit(s) will be counted as incomplete with liquidated damages assessed

accordingly.

#### 5.2.4 - Dead and Down Creation

##### 5.2.4.2 - Dead and down creation, hare and grouse (1/14)

To improve habitat for snowshoe hare, grouse, and other species, the Purchaser is to leave one tree, nine (9) inches or larger in diameter on the ground for every two acres in Payment Unit 1. They should be scattered throughout the Sale Area or positioned per the Sale Administrators' instructions. Note these pieces should have a minimum length of five feet. They can be of any tree species and can be an un-merchantable piece of wood or a full tree. In addition, place at least four (4) brush piles along the western edge of Payment Unit 1 along the lowland boundary. Place pieces of a large log or stump at the bottom of the piles to create cavities within the brush pile.

#### 5.2.22 - Operating Caution

##### 5.2.22.2 - Operating caution (6/11)

It is recommended, but not required, that within Payment Unit(s) 1, cutting, skidding, and hauling occur during dry summer or frozen winter conditions. The reason for the recommendation is because of low ground areas present within Payment Unit 1.

#### 5.2.32 - Decking/landing restoration (9/13)

All decking and landing areas must have the surface area restored to a condition equal to or better than before. This is to ensure the proper regeneration of the stand. Wood debris, chips, and "cookies" from trimmings must be removed or scattered away from landing and loading areas and may not be windrowed on the edge.

## 6 - Safety and Fire Prevention

### 6.2 - Signing

#### 6.2.1 - Road posting (10/20)

The Purchaser is responsible for posting and maintaining caution signs on all county roads impacted by the sale prior to beginning operations. The road must be posted at appropriate distances from the Sale Area to warn of logging activity and truck traffic. Signs must be removed when harvest operations are suspended or completed. The Purchaser will provide these signs.



**TIMBER SALE MAP**

This information provided by authority of Part 525, 1994 PA 451, as amended.

Sale Number	Year
71 - 004	24

Forest Management Unit Roscommon	County Roscommon	Mapped By Martell	Date 11/29/23	Page 1	of 2
Township 24N	Range 03W	Section(s) and Subdivision(s) Sec. 1 - NWNW; Sec. 2 - SESW; Sec. 11 - NESE; Sec. 12 - SWSW; Sec. 13 - NENW	Cruised By Martell and Lewicki	Scale 1:15,840	

**Cover Type**

A = Aspen	H = Hemlock	N = Marsh	U = Upland Brush
B = Paper Birch	J = Jack Pine	O = Oak	UM = Upland Mixed
C = Cedar	L = Lowland Brush	P = Lowland Poplar	V = Bog or Marsh
D = Treed Bog	LM = Lowland Mixed	Q = Mixed Swamp Conifer	W = White Pine
E = Swamp Hdwoods	M = Mpl, Bch, Brch	R = Red Pine	X = Non Stocked
F = Spruce Fir	MC = Mixed Conifer	S = Black Spruce	Z = Water
G = Grass	MD = Mixed Deciduous	T = Tamarack	

**Density**

0 = Non Stocked	5 = Pole Timber Medium
1 = Seedling Sapling Poor	6 = Pole Timber Well
2 = Seedling Sapling Medium	7 = Saw Timber Poor
3 = Seedling Sapling Well	8 = Saw Timber Medium
4 = Pole Timber Poor	9 = Saw Timber Well

PU	Acres	PU	Acres
1	13.1	4	3.0
2	13.9	5	3.5
3	3.4		

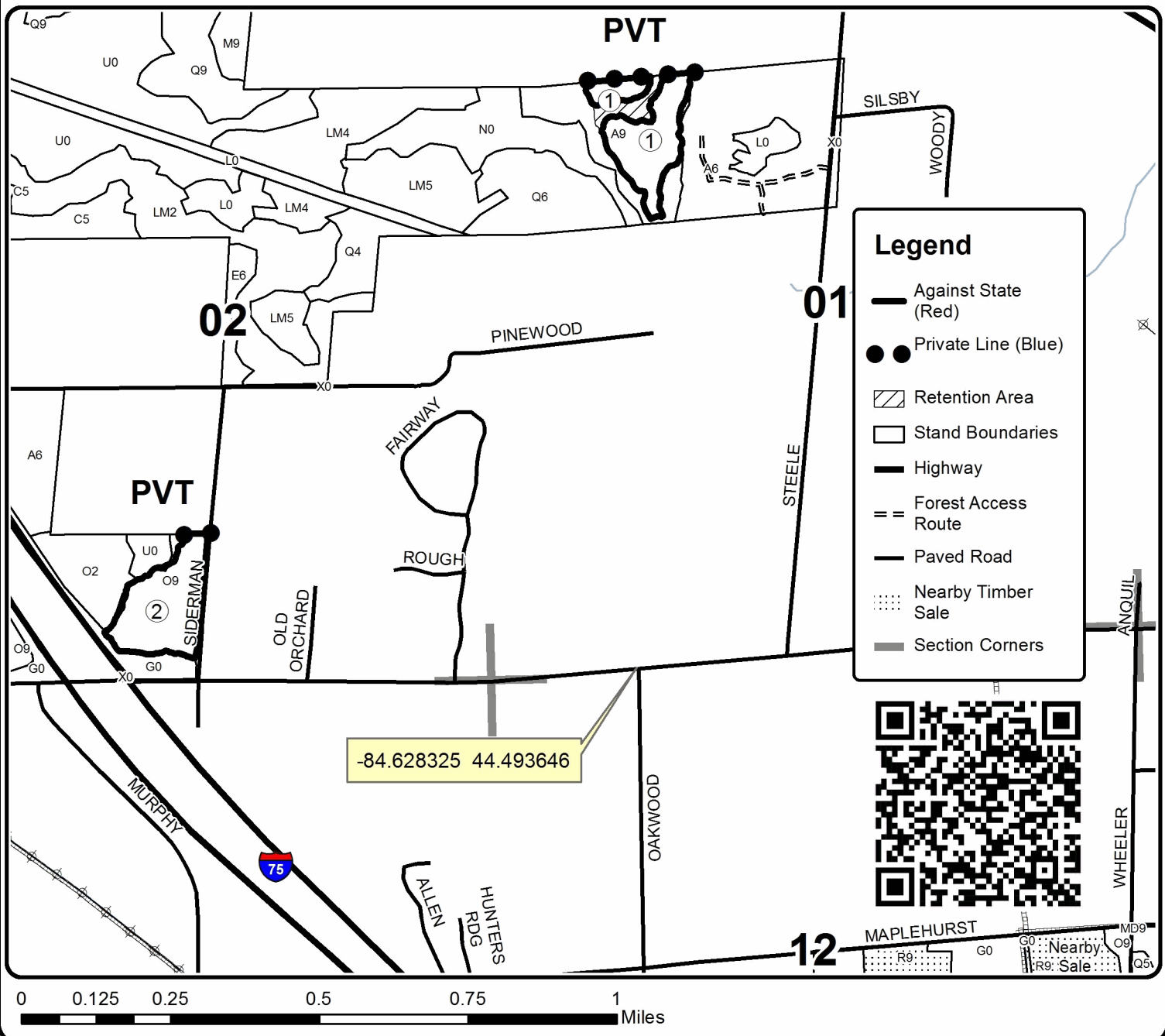
**Triangle Mix**  
**Compartment 32**  
**36.9 Acres**

**TIMBER SALE MAP**

This information provided by authority of Part 525, 1994 PA 451, as amended.

Sale Number

71 - 004

Year

24

Forest Management Unit

Roscommon

County

Roscommon

Mapped By

Martell

Date

11/29/23

Page

2

of

2

Township

24N

Range

03W

Section(s) and Subdivision(s)

Sec. 1 - NWNW; Sec. 2 - SESW; Sec. 11 - NESE;  
Sec. 12 - SWSW; Sec. 13 - NENW

Scale

1:7,920

**Cover Type**

A = Aspen  
B = Paper Birch  
C = Cedar  
D = Treed Bog  
E = Swamp Hdwoods  
F = Spruce Fir  
G = Grass  
H = Hemlock  
J = Jack Pine  
L = Lowland Brush  
LM = Lowland Mixed  
M = Mpl, Bch, Brch  
MC = Mixed Conifer  
MD = Mixed Deciduous  
N = Marsh  
O = Oak  
P = Lowland Poplar  
Q = Mixed Swamp Conifer  
R = Red Pine  
S = Black Spruce  
T = Tamarack  
U = Upland Brush  
UM = Upland Mixed  
V = Bog or Marsh  
W = White Pine  
X = Non Stocked  
Z = Water

**Density**

0 = Non Stocked  
1 = Seedling Sapling Poor  
2 = Seedling Sapling Medium  
3 = Seedling Sapling Well  
4 = Pole Timber Poor  
5 = Pole Timber Medium  
6 = Pole Timber Well  
7 = Saw Timber Poor  
8 = Saw Timber Medium  
9 = Saw Timber Well

PU	Acres	PU	Acres
1	13.1	4	3.0
2	13.9	5	3.5
3	3.4		

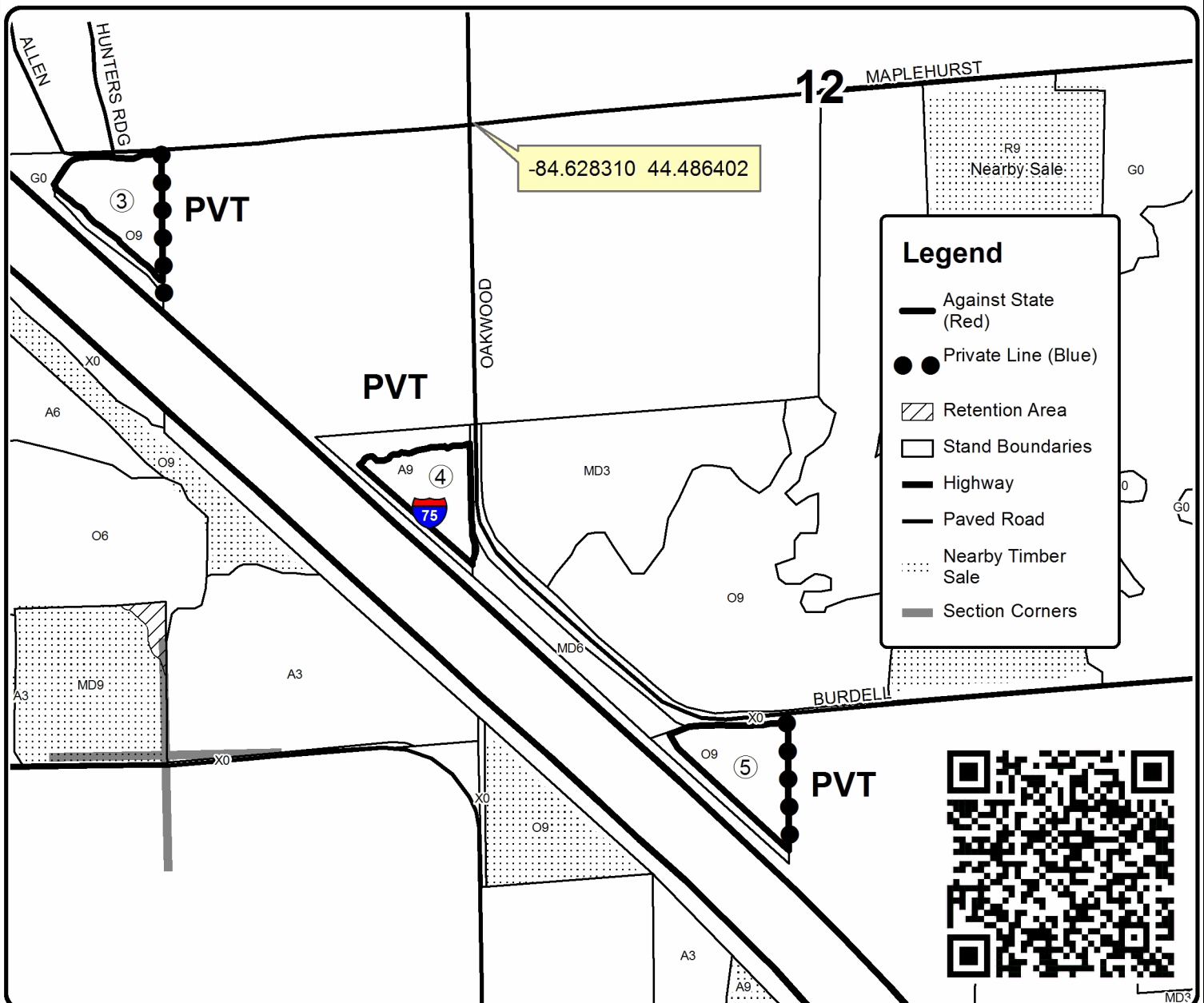
**Triangle Mix**  
**Compartment 32**  
**36.9 Acres**

0 0.125 0.25 0.5 0.75